

GrouNZ Adapter Flange

The Large Surface Adapter for Multiple Attachments

The flange adapter, identical to the GrouNZ Flat Top plate, provides multiple options for attachment and a large surface to position it accurately. It fits into the GrouNZ Flex screw via the central M20 fixing hole.

GrouNZ Adapter Bearer U	
Diameter (mm)	200
Thickness (mm)	8
Fixing Slots Size (mm)	14
Central Hole Thread	M20

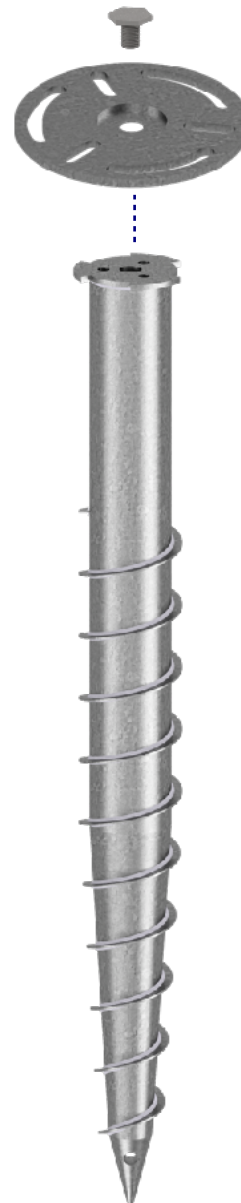

Steel	ISO 630 FE 360D
Galvanisation	ISO 1461
Manufacturing	ISO 9001